

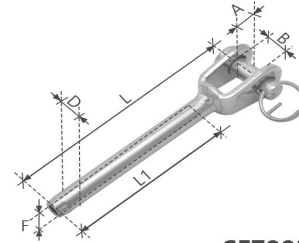

ARCUS WIRE GROUP

MARINE • INDUSTRIAL • ARCHITECTURAL



SF7803

PRODUCT DATA SHEET

| CODE | A (mm) | B (mm) | D (mm) | F (mm) | L (mm) | L1 (mm) | Dia Cable (inch) | Box Qty | B.L.(1) (kgs) |
|---------------|--------|--------|--------|--------|--------|---------|------------------|---------|---------------|
| AWG-6780-3332 | 5 | 7 | 5.53 | 2.70 | 62 | 35 | 3/32" | 1,500 | 700 |
| AWG-6780-3718 | 6 | 8 | 6.35 | 3.50 | 68 | 38 | 1/8" | 1,000 | 1,250 |
| AWG-6780-3532 | 8 | 11 | 7.54 | 4.30 | 77 | 45 | 5/32" | 500 | 1,800 |
| AWG-6780-3316 | 9 | 12 | 9.12 | 5.10 | 87 | 51 | 3/16" | 250 | 2,650 |
| AWG-6780-3732 | 9 | 12 | 10.84 | 5.90 | 93 | 57 | 7/32" | 150 | 3,000 |
| AWG-6780-3714 | 12 | 14.5 | 12.54 | 6.70 | 109 | 64 | 1/4" | 150 | 4,000 |
| AWG-6780-3615 | 14.28 | 15 | 16.13 | 8.40 | 148 | 80 | 5/16" | 70 | 7,250 |
| AWG-6780-3318 | 16 | 17 | 17.85 | 9.90 | 154 | 90 | 3/8" | 50 | 8,400 |

TECHNICAL DATA

| | |
|--------------------|-------------------------|
| Forging Material: | AISI316 - DIN 1.4401 |
| Production: | SF7803 - Shackle - Cast |
| Surface Treatment: | "E. P" Electro Polished |

100%
RECYCLABLE

PRODUCTION CODE: SF7803

hamma™ Industrial - Swage Forks - Imperial